



LOUISVILLE
REGIONAL
AIRPORT
AUTHORITY®

For more information:

Trish S. Burke 502-363-8506
Digital Pager 502-332-2244

Media Advisory Crittenden Drive Rerouting

Louisville, KY (August 24, 2012)–**On Tuesday, August 28 at 3 p.m.**, construction of the South Connector (Phase 1) of the Crittenden Drive Relocation Project will be finished and the new roadway and bridge over the CSX railroad tracks connecting to Strawberry Lane will be open to traffic. At that time, Crittenden Dr. (from the 90-degree turn near the Republic Airways hangar to Maclean Ave.) **will be permanently closed.** (See map below for new route and directions.)

Relocating the roadway allows for the construction of Taxiway “A”, a crucial airfield improvement, which permits the airport to handle the newest, largest long-range commercial aircraft.

The South Connector was funded with \$5 million from the Commonwealth of Kentucky and \$6 million from the Louisville Redevelopment Authority.

Crittenden Drive Rerouting Map

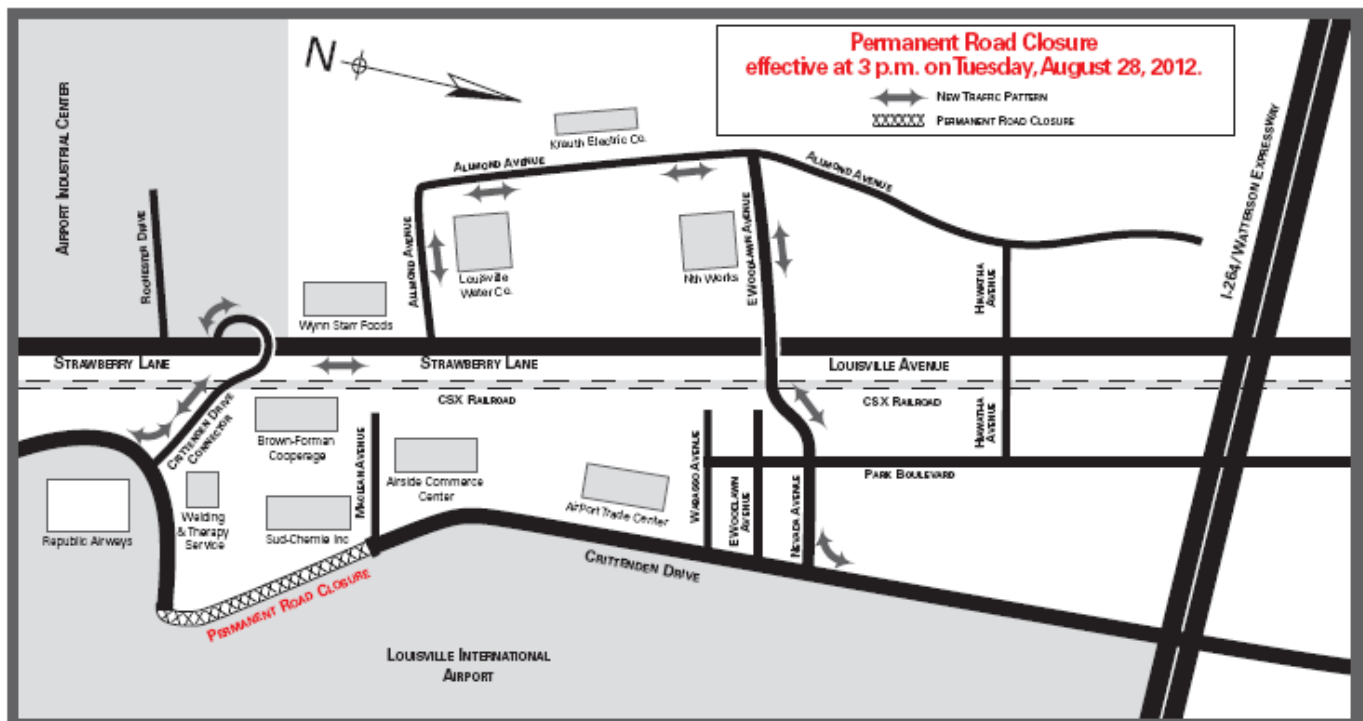

Heading North (towards I-264/Watterson Expressway):

- Follow Crittenden Drive north
- Left on Crittenden Drive Connector (crossing over CSX railroad tracks) or bear right for Welding & Therapy Service or Republic Airways
- Left on Strawberry Lane
- Left on Allmond Avenue
- Right on Woodlawn Avenue (overpass) that becomes Nevada Avenue
- Turn left or right back on Crittenden Drive

Heading South (towards Grade Lane area):

- Follow Crittenden Drive south
- Right on Nevada Avenue that becomes Woodlawn Avenue (overpass)
- Left on Allmond Avenue
- Right on Strawberry Lane
- Right on Crittenden Drive Connector (crossing over CSX railroad tracks)
- Turn right to continue on Crittenden Dr. south or turn left for Welding & Therapy Service and Republic Airways