

Bowman Business Center

2700 Moran St.
Louisville, KY 40205

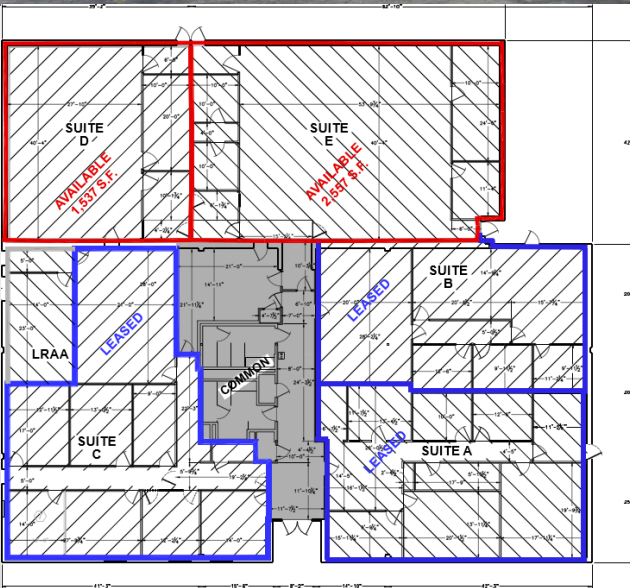

Features

- Suite D – 1,536 sq. ft.
- Suite E – 2,544 sq. ft.
- Flexible Lease Term
- Private/Low Traffic Setting
- Raised Flooring for Cable Runs
- High Speed Internet Available
- Easy access to I-264 & I-64

Lori Devore, CTA
Properties Specialist
502-363-8543
lori.devore@flylouisville.com

Cameron Sidor, C.M., ACE
Operations Specialist
502-363-8510
cameron.sidor@flylouisville.com