

Bowman Business Center

2700 Moran St.
Louisville, KY 40205

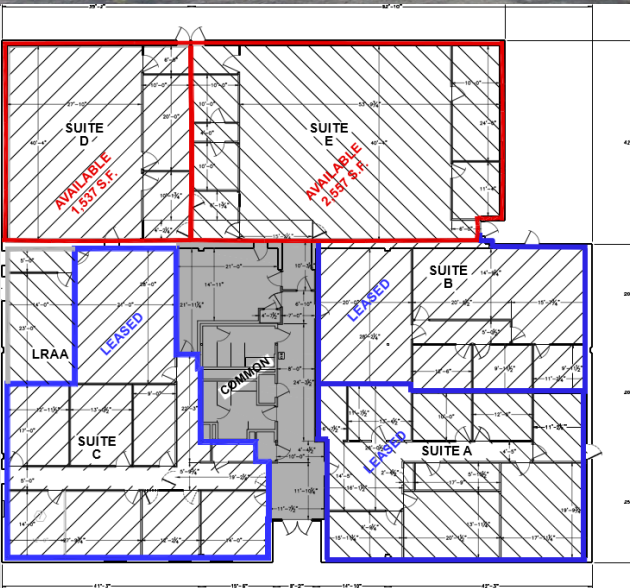

Features

- Suite D – 1,536 sq. ft.
- Suite E – 2,544 sq. ft.
- Flexible Lease Term
- Private/Low Traffic Setting
- Raised Flooring for Cable Runs
- High Speed Internet Available
- Easy access to I-264 & I-64

Contact

Adam Thomas
Director of Properties
502-363-8508
adam.thomas@flylouisville.com

Jonathan Giardina
Properties Supervisor
502-363-8510
jonathan.giardina@flylouisville.com