

# Bowman Business Center

2700 Moran St.  
Louisville, KY 40205

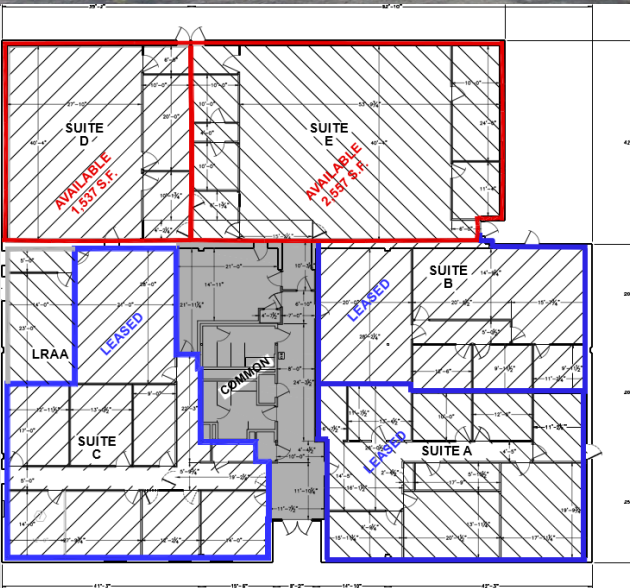

## Features

- Suite D – 1,536 sq. ft.
- Suite E – 2,544 sq. ft.
- Flexible Lease Term
- Private/Low Traffic Setting
- Raised Flooring for Cable Runs
- High Speed Internet Available
- Easy access to I-264 & I-64

## Contact

Adam Thomas  
VP of Airport Properties and Concessions  
502-363-8508  
adam.thomas@flylouisville.com

Jonathan Giardina  
Properties Supervisor  
502-363-8510  
jonathan.giardina@flylouisville.com